

1ST ON MAIN

The Residences



Luxury condominiums in the heart of downtown Carmel



WEDGEWOOD
BUILDING COMPANY





THE RESIDENCES AT 1ST ON MAIN. Part of the new 1st ON MAIN mixed-use development located at in the heart of downtown Carmel at Main Street and Range Line Road, the condominiums will range in size from 3,000 to 3,200 square feet, including balcony and porch spaces.

Each 2-story unit features a luxurious primary bedroom suite, outdoor balconies, reserved garage parking, and secure building access. Finishes include:

- Hardwood and tile flooring throughout, includes stained wood stair treads with carpet runner for stairs
- Mouser custom cabinetry
- Brizo plumbing fixtures
- Tiled showers
- Appliance packages include Wolf, Subzero and Cove brands
- Black-clad Weather Shield windows with automated shades by Drapery Street
- Generous lighting allowance
- Quartzite kitchen tops, backsplash, quartz tops in bathrooms & laundry room
- 8' solid core doors, painted 1x8 pine base and 3 1/4" casing
- Sherwin Williams Emerald paint, choice of two wall colors; 1 trim color
- Two reserved parking garage spaces; additional storage unit space available
- Concrete floor system and acoustic insulation to minimize noise transfer

For more information, contact Jessica at 317.379.2397 | WedgewoodBC.com/1stOnMain

Unit 2: 3D Floorplan –3 bedroom; 4 bathroom



Lower Level



Upper Level

Unit 2: Kitchen Finish Selections



**Hardwood: Naturally Aged Flooring: Royal Collection
White Mist**



**Kitchen Cabinets: Richmond
Perimeter : Painted Divinity
Island: Stained Cadet**



**Kitchen Faucet: Brizo Litze Arc Faucet
Black/Gold**



**Countertops: & Backsplash:
Bianco Superiore Quartzite**

Unit 2: Kitchen Appliance Selections



BEST
Series CP5 Range Hood



Wolf
36" Dual Fuel Range



Cove
24" Dishwasher



Wolf
24" Microwave Drawer

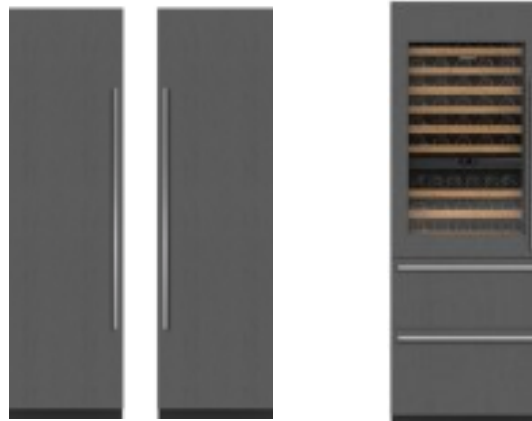

Subzero
24" Column Fridge & Freezer | 30" Wine

Fridge/Freezer, Wine Fridge & Dishwasher all panel ready

Unit 2: Primary Bathroom Selections First Floor



**Floating Vanity: Richmond
Stained Cadet**



**Countertop: Quartz
Vardara Sterling Light**

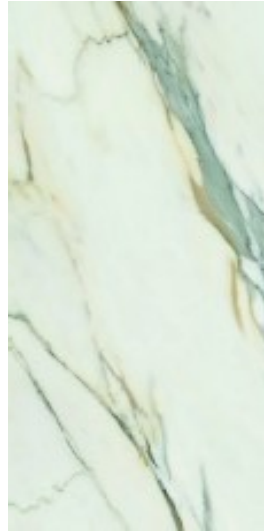

**Shower Floor: Daltile
Raine
Stratus White
Shower Wall: Soci**



**Faucet & Fixtures: Allaria
Luxe Gold**

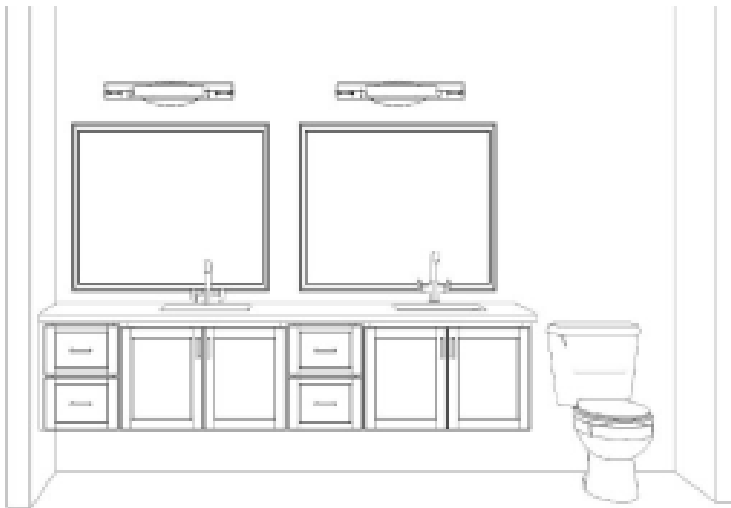

Unit 2: Powder Room Bath Selections



Countertop: Quartz
Taj Mahal

Floating Vanity: Amity
Painted Carbide



Faucet & Fixtures: Allaria
Luxe Gold



Mirror: Uttermost Varina
Gold



Unit 2: Primary Bathroom 2nd Floor



**Floating Vanity: Richmond
Stained Cadet**



**Shower Floor: Soho Penny
Round**

Warm Gray

**Shower Wall: Ergon Trend
5 x 10 Black**

**Faucet & Fixtures: Virage
Luxe Gold**



Unit 2: Guest Bath Selections



**Floating Vanity: Amity
Painted Creekstone**

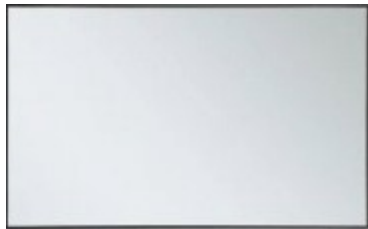

**Countertops: Quartz
Vardara Sterling Light**

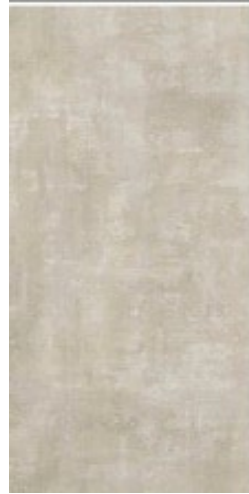

**Shower Floor: Virginia Tile Hex—Dark Grey
Shower Wall: Soho Runway Series—12x24 Ash**



**Fixtures & Faucet: Jason Wu (Odin)
Matte Black | Mirror Metal Frame Black**

Unit 2: Laundry Room Selections



**Floating Vanity: Amity
Painted White**



**Countertop: Quartz
Pure Gray**



**Faucet: Odin
Stainless**

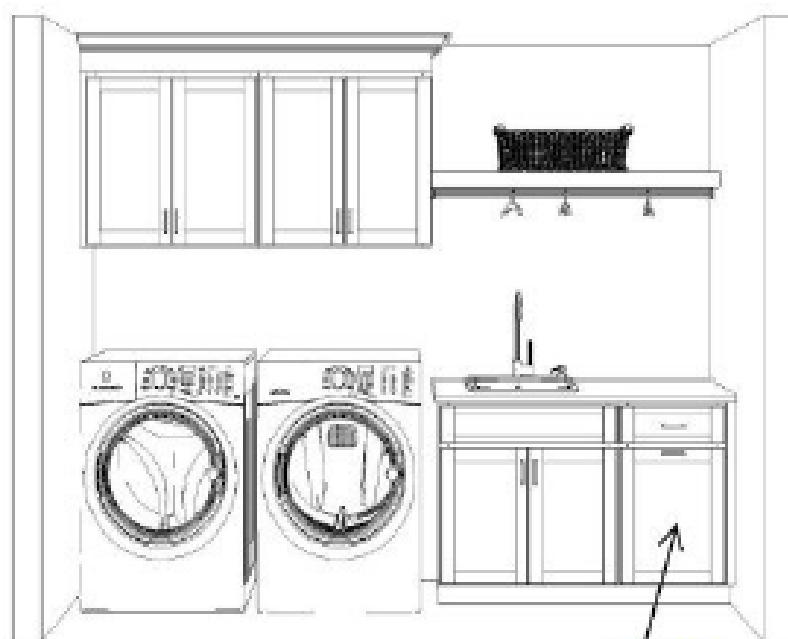

**SINGLE
PULL OUT
TRASH**

**EIGHT
CONDOMINIUMS.
ONLY A FEW REMAIN.**



1ST ON MAIN

Exclusive luxury condominiums located in the heart of downtown Carmel

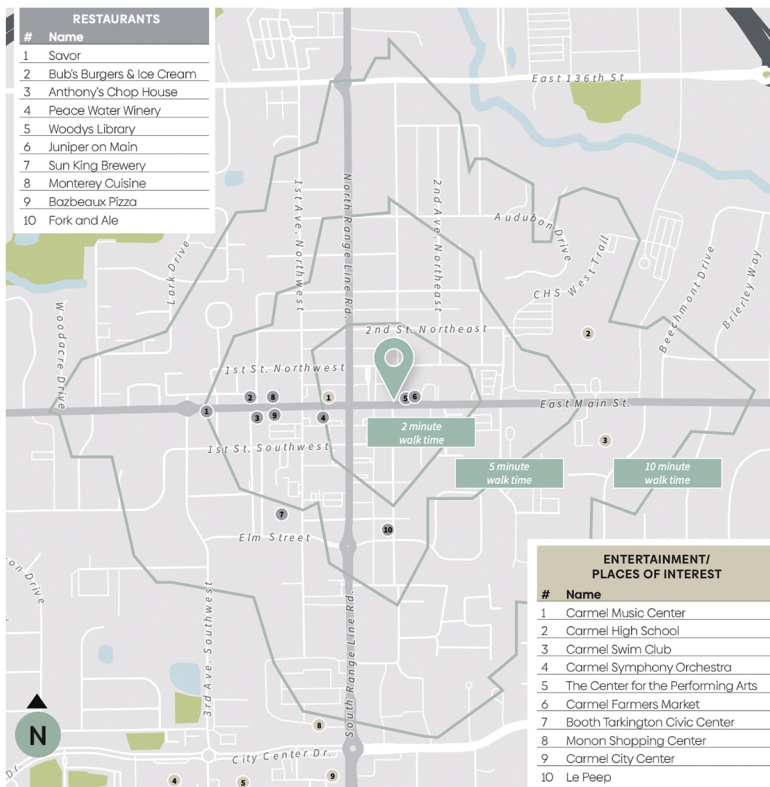

THE RESIDENCES AT 1ST ON MAIN. Part of the new 1st On Main mixed-use development located at the northeast corner of Main Street and Rangeline Road, the condominiums will range in size from 3,000 to 3,300 square feet, including balcony and porch spaces.

Each 2-story unit features a luxurious owner's suite, outdoor balconies, reserved garage parking, and secure building access. Upscale Wolf and Subzero appliances are complemented by Brizo plumbing fixtures, hardwood flooring throughout the living areas and bedrooms, custom cabinets and automated window treatments along with other high-end finishes and touches. Prices start at \$1.5M.

Residents will enjoy living in Carmel's vibrant, walkable Arts & Design District with easy access to restaurants, shops, and community-wide celebrations.

Parking Garage

Reserved Condo Parking

The Residences at
1ST ON MAIN

1ST FLOOR

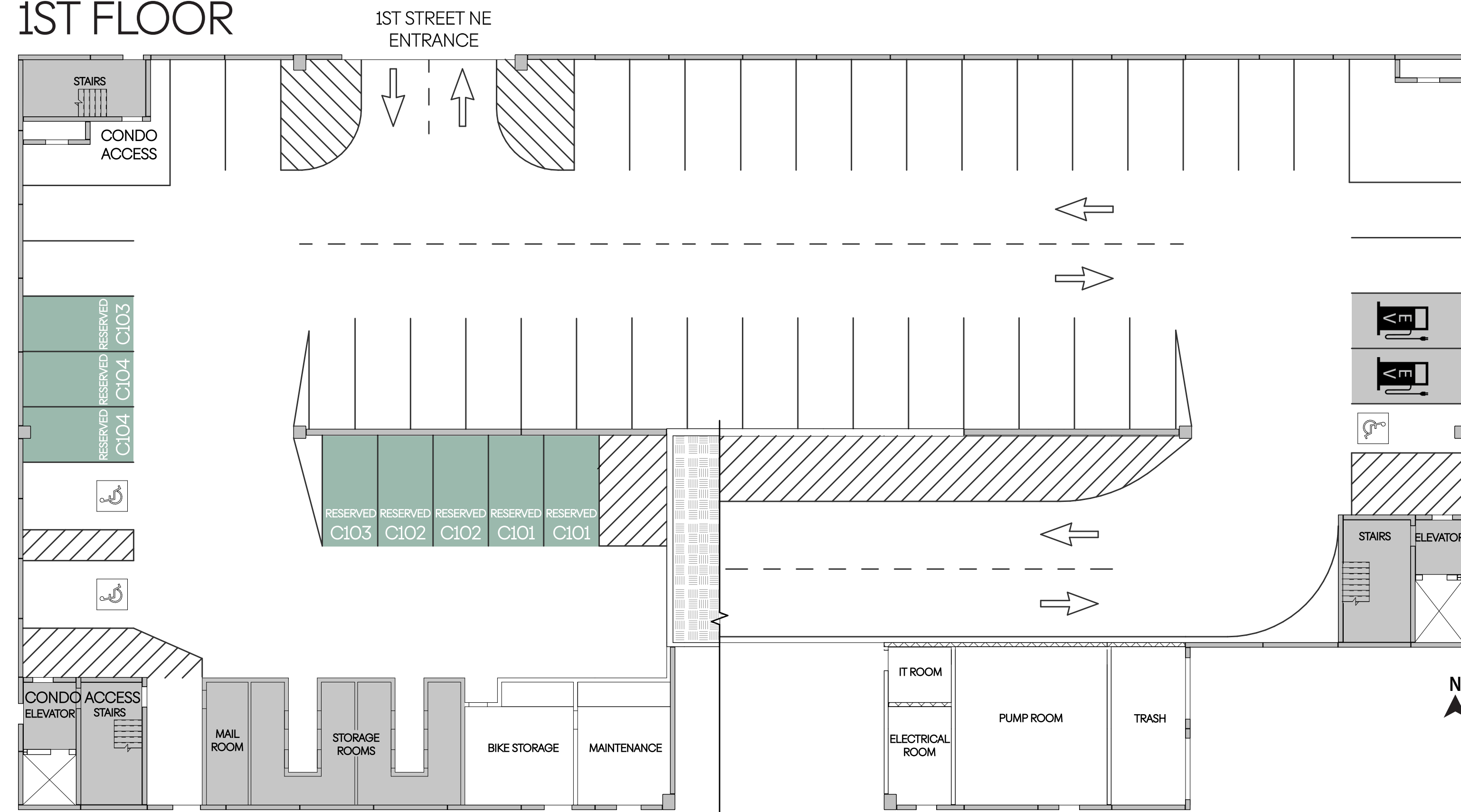

3RD FLOOR

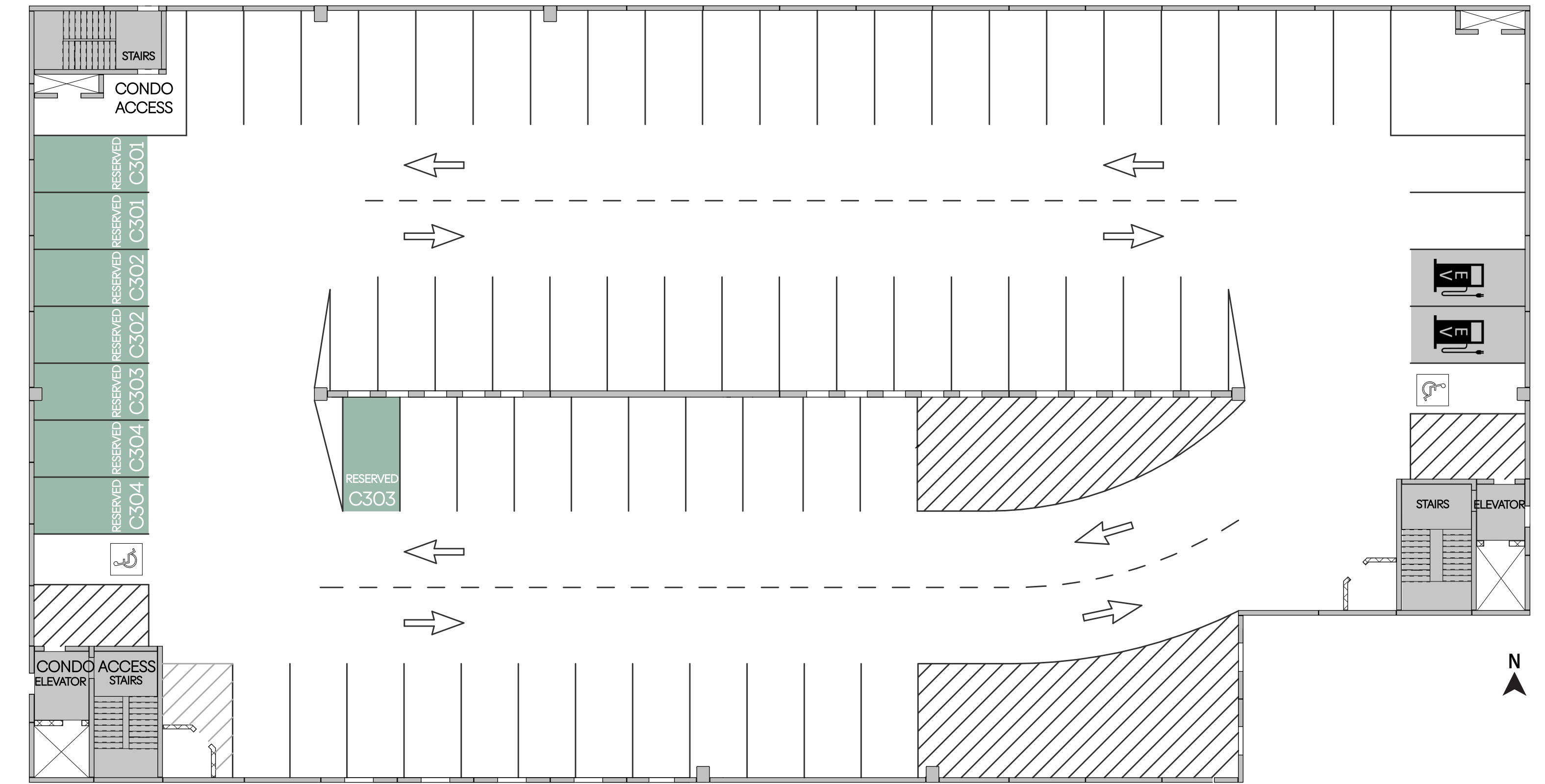

2ND FLOOR

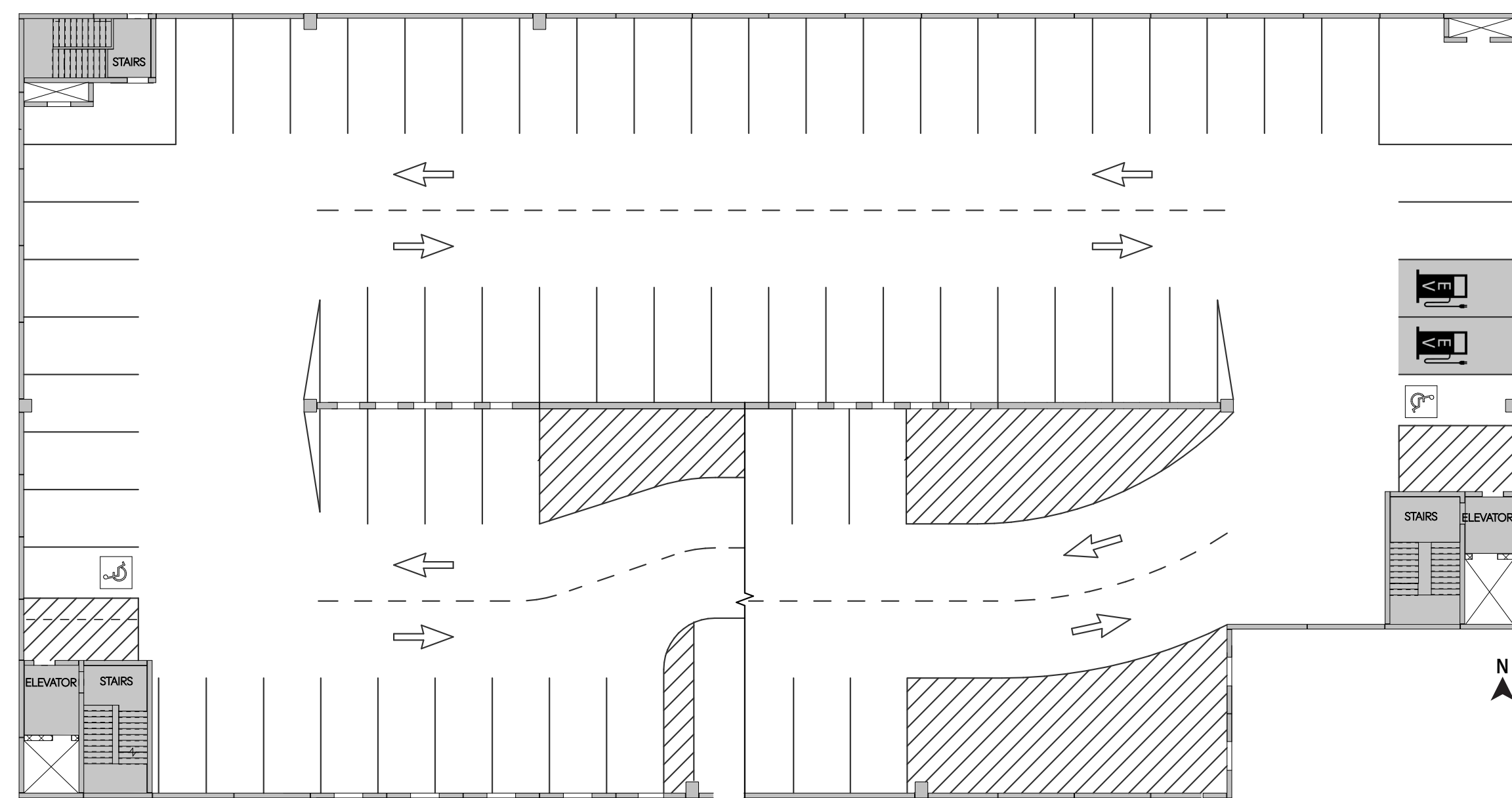

4TH FLOOR

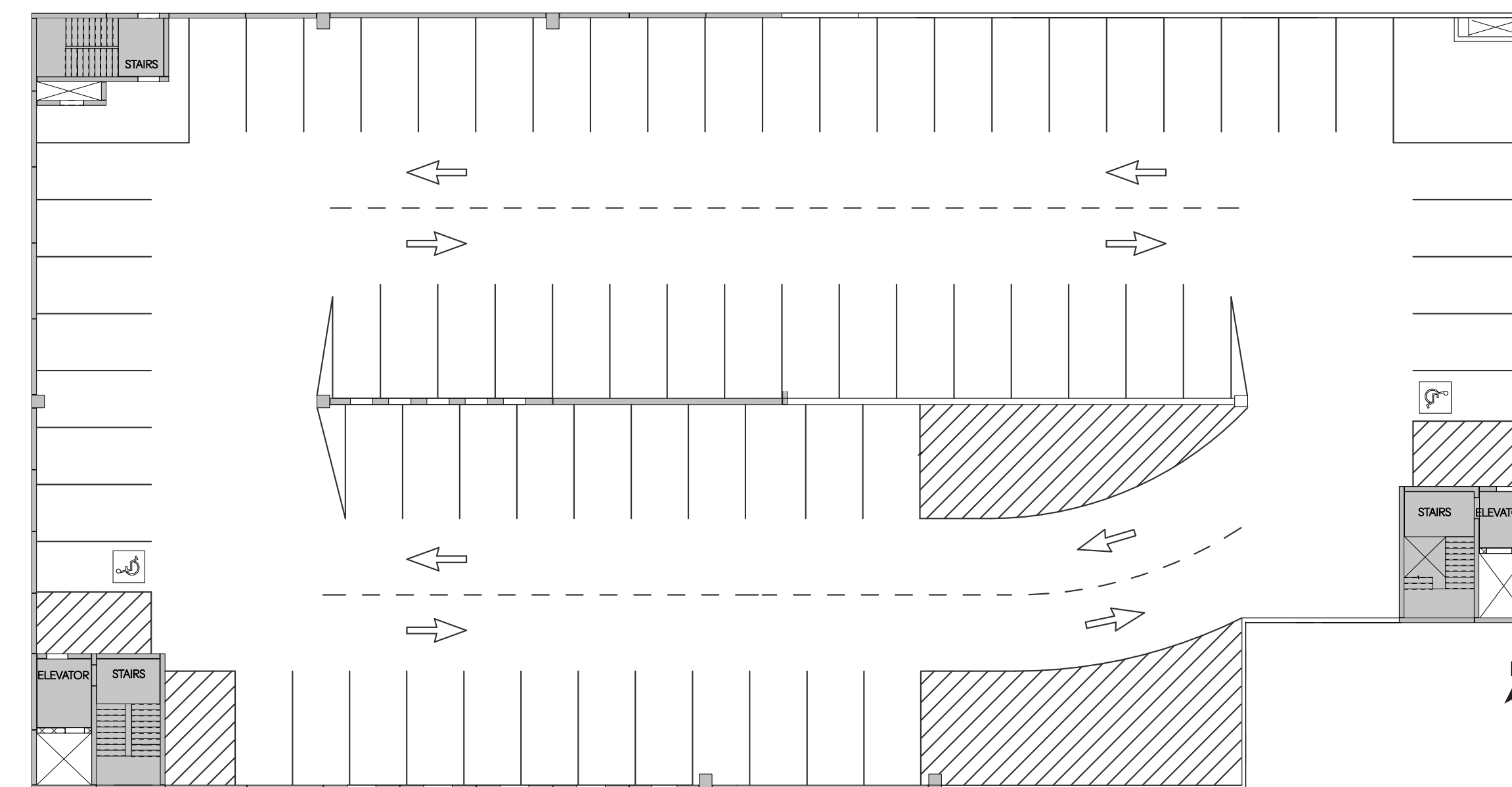

5TH FLOOR

